

NOTES (UNLESS OTHERWISE SPECIFIED)

1. LINEAR SPECIFICATIONS:

LINEAR STROKE: 10 mm
 ENC. RESOLUTION(+A/-A;+B/-B): 1, 5 um
 ENCODER REPEATABILITY: ±4 COUNTS
 OPERATING VOLTAGE: 24 Vdc
 COIL RESISTANCE: 20± 5 % Ohm
 MAXIMUM CURRENT 1.2 A @ 24Vdc
 PEAK FORCE: 3.5 N @ 24Vdc
 FORCE CONSTANT: 2.9 N/A
 MOVING MASS: 37 g (VACUUM)
 34 g (NON VACUUM)

TOTAL MASS: 210g (VACUUM, W/O CABLE)
 207 g(NON VACUUM, W/O CABLE)

2. VACUUM OPTION: YES

3. SPRING OPTION: YES

4. OPERATING TEMPERATURE: 0°C TO 40°C

5. TOLERANCES

X.: ±0.5

X.X: 0.25

6. THESE HOLES ARE FOR SMAC INTERNAL ONLY

REVISIONS				
REV	ECR	DESCRIPTION	DATE	APPROVED
A	-	INITIAL RELEASE	1/24/2017	TW
B	5987	CORRECTED PINOUT	3/20/2017	TW
C	6080	M2∇4.0 WAS M2∇5.5	5/8/2017	TW
D	6118	ADDED 2 HOLES FOR SMAC INTERNAL PURPOSE	6/27/2017	TW

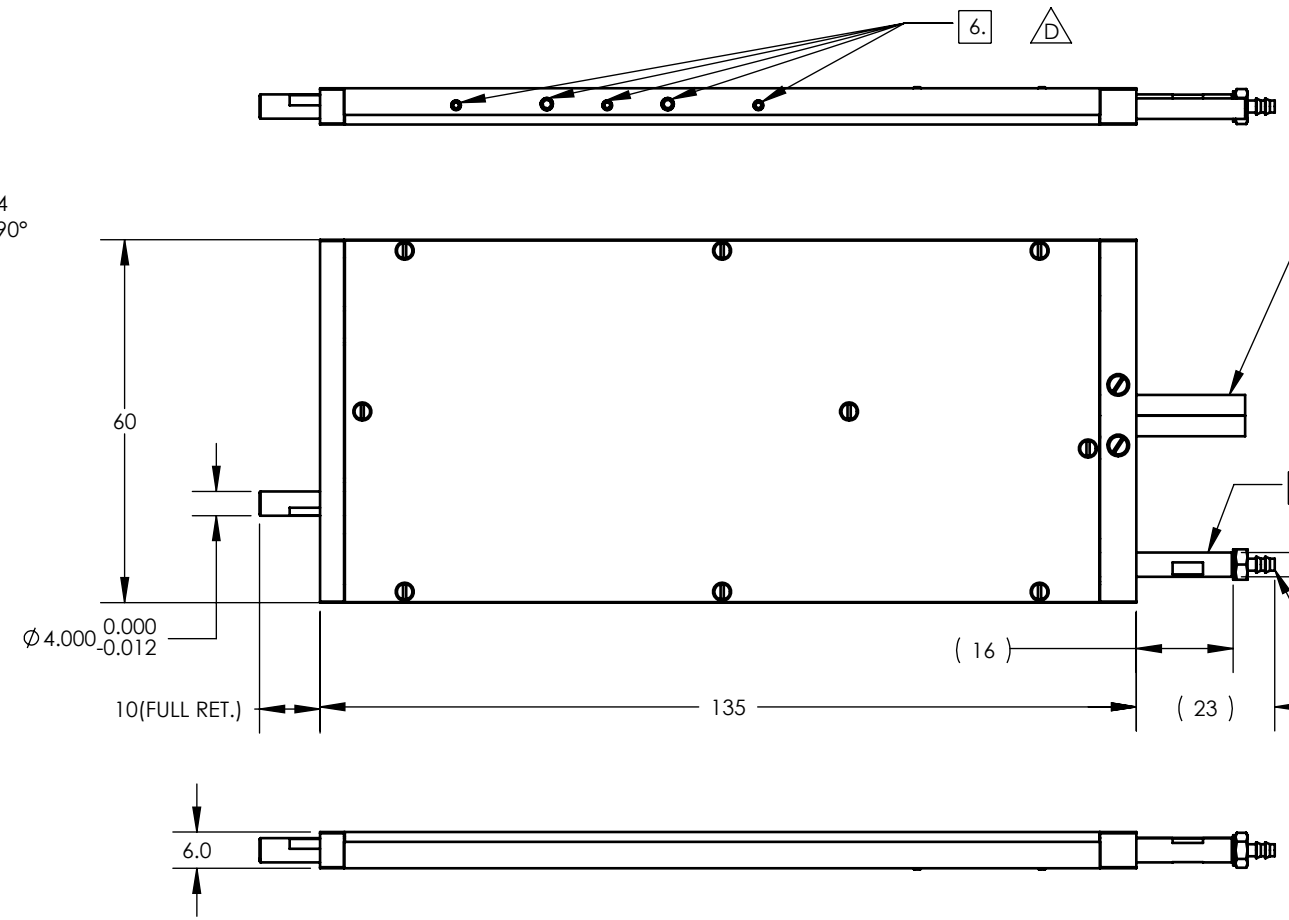
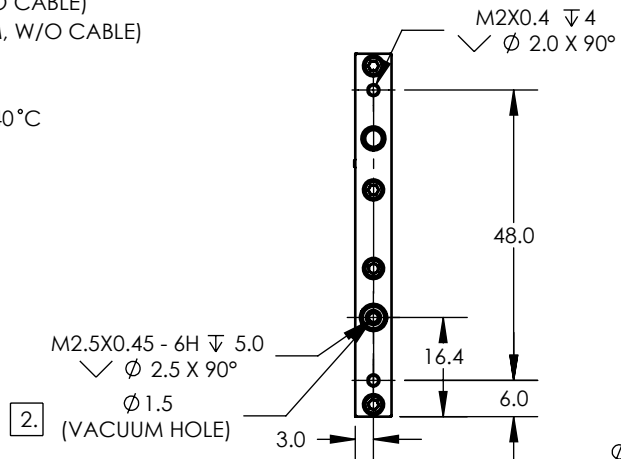

CABLE EXTEND
 PIG TAIL (LG=0.5m, DB-26)
 FLYING LEAD (LG=3m, DB-15, POWER)

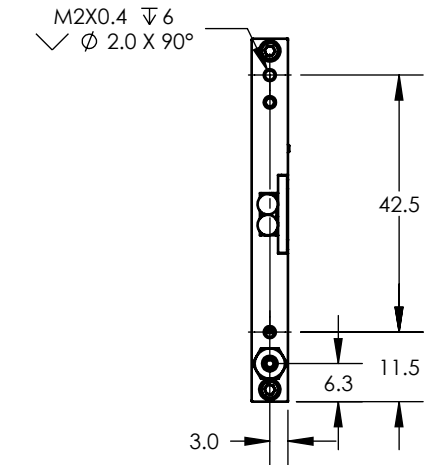

VACUUM AIR FITTING
 SMC# M-3AU-3

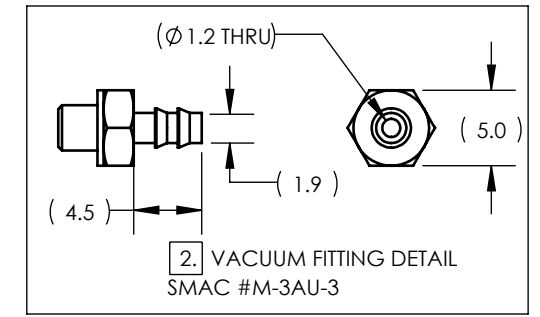
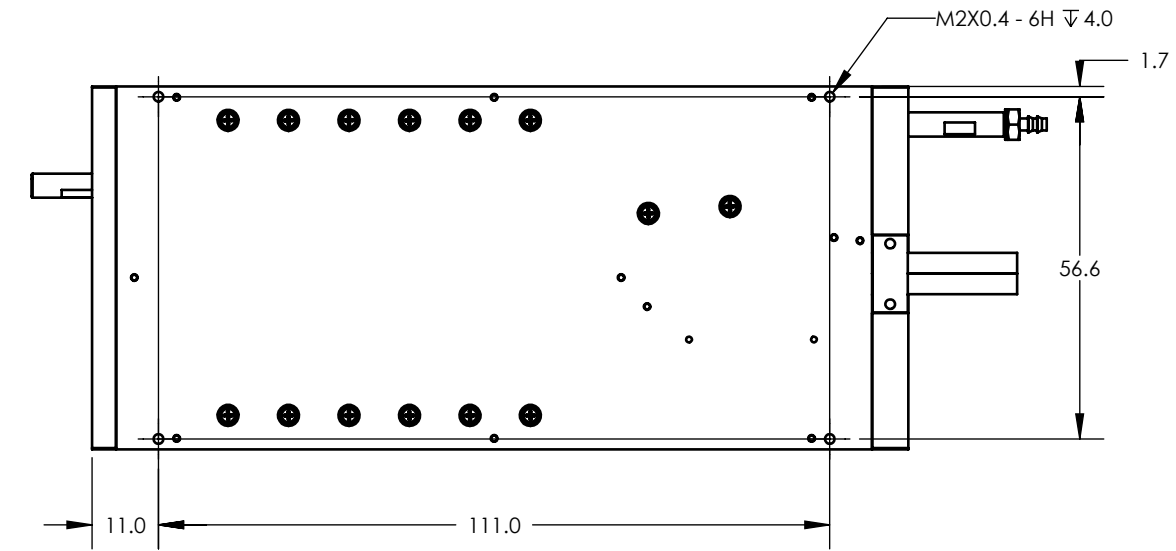

DP-26P

PIN No	Details
1	(L) PH. A+
2	(L) PH. B+
3	(L) PH. Z+
4	NC
5	NC
6	NC
7	NC
8	NC
9	NC
10	(L) PH. A-
11	(L) PH. B-
12	(L) PH. Z-
13	NC
14	NC
15	NC
16	NC
17	NC
18	NC
19	+5 VDC
20	5V RTN
21	L. COIL+
22	L. COIL+
23	L. COIL -
24	L.COIL -
25	NC
26	NC

DB 15P

PIN No	DB-15P
1	PH. A+
2	PH. Z+
3	PH. B+
4	+5 Vdc
5	NC
6	NC
7	NC
8	NC
9	PH. A -
10	PH. Z -
11	PH. B -
12	5V RTN
13	NC
14	NC
15	NC

POWER

PIN No	Details
1	GND
2	+V
3	COIL (+)
4	COIL (-)

UNLESS OTHERWISE SPECIFIED
 ALL DIMENSIONS ARE IN MM
 BREAK EDGES AND REMOVE BURRS
 TOLERANCES
 X.: ±0.5 X.X: ±0.1
 X.XX: ±0.05 ANGLE: ±0.1°
 CONCENTRICITY: ±0.025
 ROUNDNESS: ±0.025
 EDGE BREAKS: 0.2 MAX
 ALL DIMENSIONS AND TOLERANCES ARE FINAL

MATERIAL: SEE BOM
 FINISH: SEE BOM
 MACHINE FINISH: 1.6
 INTERPRET PER: ASME Y14.5-2009
 THIRD ANGLE PROJECTION

NAME	DATE
DWN BY: TW	1/24/2017
CHK BY: TMV	1/24/2017
ENG APP: TMV	1/24/2017
MFG APP:	
QA APP:	

SMAC 5807 VAN ALLEN WAY
 CARLSBAD CA, 92008 (760) 929-7588

MOVING COIL ACTUATORS

TITLE: **LCA6-010-XX-3**

PROPRIETARY AND CONFIDENTIAL

THE INFORMATION CONTAINED IN THIS DRAWING IS THE SOLE PROPERTY OF SMAC. ANY REPRODUCTION IN PART OR AS A WHOLE WITHOUT THE WRITTEN PERMISSION OF SMAC IS PROHIBITED.

SIZE: **B** PART NO: **LCA6-010-XX-3** REV: **D**

SCALE: 8:10 **DO NOT SCALE** SHEET: 1 / 1