

NOTES (UNLESS OTHERWISE SPECIFIED)

1. ALL DIMENSIONS ARE IN mm UNLESS OTHERWISE NOTED.
2. OPERATING TEMPERATURE: 0°C TO 45°C
3. ENCODER RESOLUTION: 5, 1, 0.1µm
4. ENCODER REPEATABILITY: 4 COUNTS

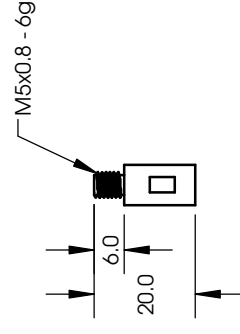
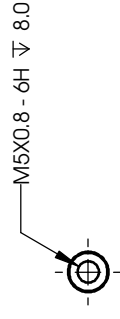
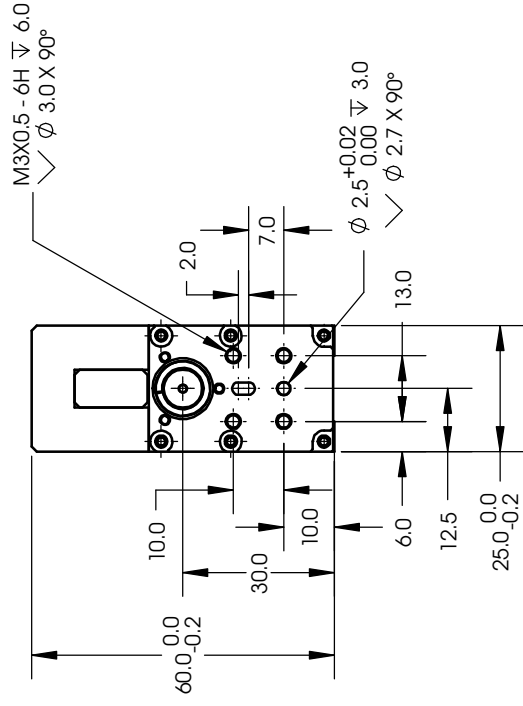

FEMALE

MALE

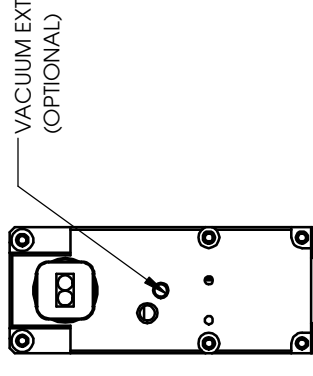
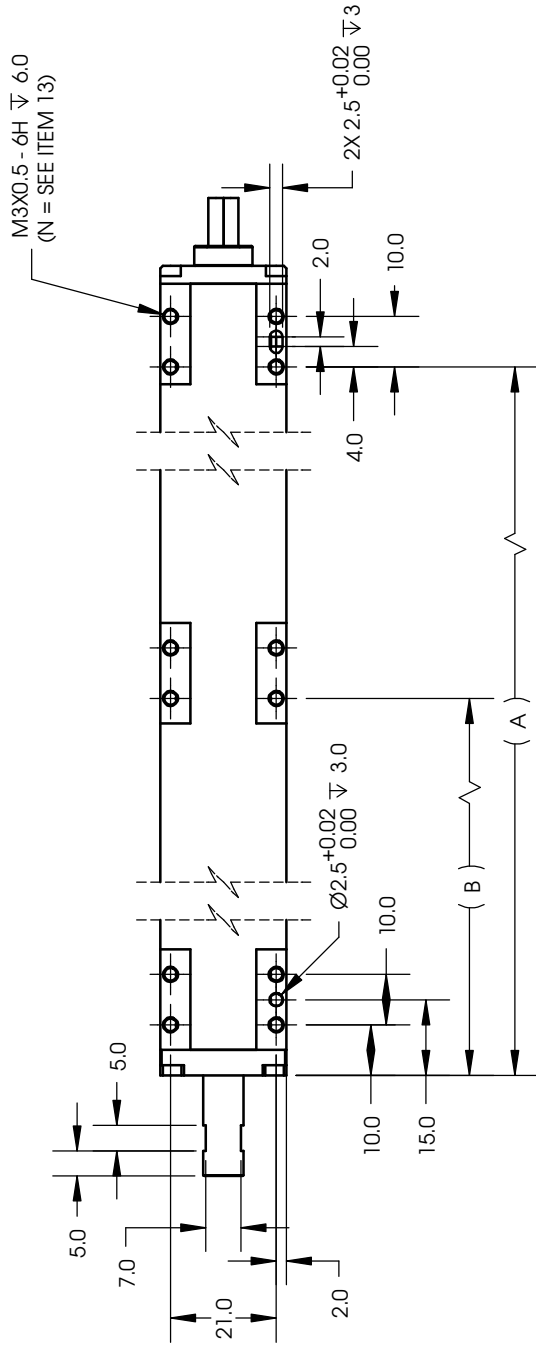
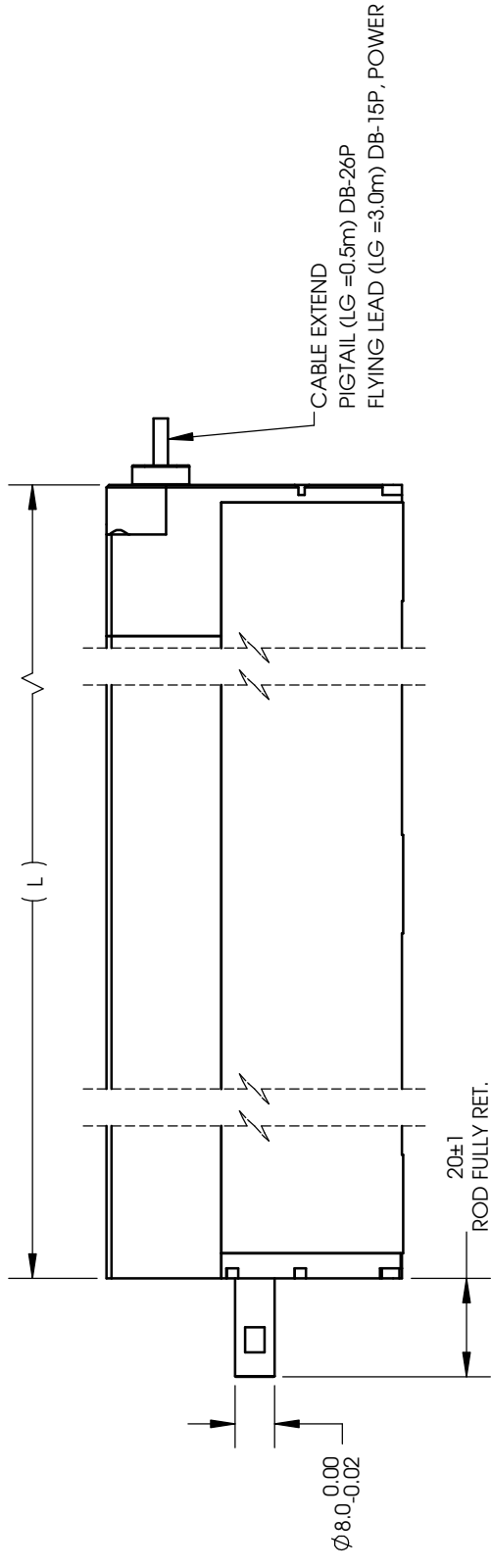

REVISIONS				
REV	ECR	DESCRIPTION	DATE	APPROVED
Q	5491	NEW PART#	11/20/2014	JF
R		ADDED 250mm STROKE	2/17/2017	BJC
S	6248	ADDED PINOUT FOR SINGLE PHASE UNIT	11/1/2017	BJC
T	6276	UPDATED SPECIFICATIONS	11/17/2017	BJC

UNLESS OTHERWISE SPECIFIED
ALL DIMENSIONS ARE IN MM
BREAK EDGES AND REMOVE BURRS

TOLEANCES
X: ±0.5 XX: ±0.1
XXX: ±0.05 ANGLE: ±0.1°
CONCENTRICITY: ±0.01
ROUNDNESS: ±0.05
EDGE BREAKS: 0.02 MAX
CHAMFER: 0.03 MAX
ALL DIMENSIONS AND TOLERANCES
ARE FINAL

MATERIAL:
FINISH:
MACHINE FINISH:
INTERPRET PER:
ASME Y14.5-2009
THIRD ANGLE
PROJECTION

NAME: BJC
DATE: 02/16/2017
DWN BY:
CHK BY:
ENG APP:
MFG APP:
QA APP:
PROPRIETARY AND CONFIDENTIAL

SMAC
MOVING COIL ACTUATORS
LCA25-XXX-YY-Z

5807 VAN ALLENWAY
CARLSBAD CA, 92008
(760) 929-7988

REV: T
SCALE: DO NOT SCALE
SHEET: 1 / 2

REF. NUMBER: LCA25 CONTRACT: LCA25

SIZE: B
PART NO: LCA25-XXX-YY-Z

THE INFORMATION CONTAINED IN THIS DRAWING IS THE
SOLE PROPERTY OF SMAC. REPRODUCTION IN PART OR AS A
WHOLE WITHOUT WRITTEN PERMISSION
IS STRICTLY PROHIBITED.

PIGTAIL

-6/-8(PIN 24 = NC)

LCA25-XXX-YY-6

PIN No	DB-26P
1	(L) PH. A+
2	(L) PH. B+
3	(L) PH. Z+
4	NC
5	NC
6	NC
7	NC
8	NC
9	NC
10	(L) PH. A-
11	(L) PH. B-
12	(L) PH. Z-
13	NC
14	NC
15	NC
16	NC
17	NC
18	NC
19	+5VDC
20	5V RTN
21	NC
22	L. COIL (U)
23	L. COIL (V)
24	L. COIL (W)
25	NC
26	NC

LCA25-XXX-YY-2

PIN No	DB-26P
1	(L) PH. A+
2	(L) PH. B+
3	(L) PH. Z+
4	NC
5	NC
6	NC
7	NC
8	NC
9	NC
10	(L) PH. A-
11	(L) PH. B-
12	(L) PH. Z-
13	NC
14	NC
15	NC
16	NC
17	NC
18	NC
19	+5VDC
20	5V RTN
21	(L) MOTOR+
22	(L) MOTOR+
23	(L) MOTOR-
24	(L) MOTOR-
25	NC
26	NC

FLYING LEAD

-6/-8(PIN 5 = NC)

FOR LCC-10 /LAC-1

POWER

LCC-10

PIN DB-15P

PIN No	DB-15P
1	PH. A+
2	PH. B+
3	PH. Z+
4	+5Vdc
5	MOTOR V (-)
6	NC
7	NC
8	NC
9	PH. A -
10	PH. Z -
11	PH. B -
12	5V RTN
13	NC
14	NC
15	NC

PIN 6P DETAIL

PIN No	6P DETAIL
1	GND
2	+V
3	MOTOR U (+)
4	MOTOR V (-)
5	MOTOR W
6	NC

LAC-1

PIN 4P DETAIL

PIN No	4P DETAIL
1	GND
2	+V
3	MOTOR +
4	MOTOR -

LCA25-XXX-YY-Z

No	DETAILS	UNIT	LCA25-010-75-2	LCA25-025-15-6	LCA25-025-35-6	LCA25-025-55-2	LCA25-025-75-2	LCA25-050-15-6	LCA25-050-35-6	LCA25-100-15-6	LCA25-100-35-6	LCA25-150-15-6	LCA25-150-35-6	LCA25-200-15-6	LCA25-200-35-6	LCA25-250-15-6	LCA25-250-35-6
1	LINEAR STROKE	mm	10	25	25	25	25	50	50	100	100	150	150	200	200	250	250
2	PEAK FORCE	N	22	15	20.5	7.4	9.2	15	20.5	15	20.5	20.5	20.5	15	20.5	15	20.5
3	FORCE CONSTANT	N/A	8	9.5	13	2.5	3	9.5	13	9.5	13	13	13	9.5	13	9.5	13
4	MAXIMUM CURRENT	Amp	3.5	1.6	1.6	3	3	1.6	1.6	1.6	1.6	1.6	1.6	1.6	1.6	1.6	1.6
5	COIL RESISTANCE	Ohm	13.0	15	30	7	13.6	15	30	15	30	30	30	15	30	15	30
6	MOVING MASS	kg	0.085	0.076	0.076	0.076	0.076	0.082	0.082	0.10	0.10	0.12	0.12	0.14	0.14	0.16	0.16
7	TOTAL MASS	kg	0.45	0.53	0.53	0.55	0.55	TBD	TBD	TBD	TBD	TBD	TBD	1.3	1.3	1.52	1.52
8	DIMENSION (L)	mm	130	130	130	130	130	155	155	205	205	258	258	310	310	362	362
9	DIMENSION (A)	mm	110	110	110	110	110	135	135	185	185	238	238	290	290	342	342
10	DIMENSION (B)	mm	N/A	N/A	N/A	N/A	N/A	N/A	N/A	90	90	115	115	140	140	192	192
11	(N) # MOUNTING HOLES		8	8	8	8	8	8	8	12	12	12	12	12	12	12	12

UNLESS OTHERWISE SPECIFIED ALL DIMENSIONS ARE IN MM. BREAK EDGES AND REMOVE BURRS.

TOLEANCES
 X: ±0.5 XX: ±0.1
 XXX: ±0.05 ANGLE: ±0.1°
 CONCENTRICITY: ±0.01
 ROUNDNESS: ±0.05
 EDGE BREAKS: 0.02 MAX
 CHAMFER: 0.03 MAX
 ALL DIMENSIONS AND TOLERANCES ARE FINAL

MATERIAL: **SMAC**
 MOVING COIL ACTUATORS
LCA25-XXX-YY-Z

FINISH: **SEE NOTES**
 MACHINE FINISH: 3.2/
 INTERPRET PER: ASME Y14.5-2009
 THIRD ANGLE PROJECTION

NAME: BIC DATE: 02/16/2017
 DWN BY: CHK BY: ENG APP: MFG APP: QA APP: PROPRIETARY AND CONFIDENTIAL

REF. NUMBER: LCA25 CONTRACT: LCA25

SCALE: **DO NOT SCALE**

REV: **T**
 SHEET: 2 / 2

5807 VAN ALLENWAY
 CARLSBAD CA, 92008
 (760) 929-7588