

NOTES: (UNLESS OTHERWISE SPECIFIED)

1. ALL DIMENSIONS ARE IN mm
2. LINEAR SPECIFICATION:
LINEAR STROKE: 50 +1.0/-0 mm
FORCE CONSTANT: 125 N/AMP (EST.)
PEAK FORCE: 500 N @ 4 AMPS (48 VDC) (EST.)
COIL DC RESISTANCE: 12 Ω 20°C (48 VDC)
COIL INDUCTANCE: TBD mH @ 1 KHz
ENCODER RESOLUTION: 5.0, 1.0, 0.5 μm
ENCODER ACCURACY: ±4 counts
3. MOVING MASS: 3.1 Kg (EST.)
4. TOTAL MASS: 34 Kg (EST.)
5. OPERATING TEMPERATURE: 0°C TO +50°C

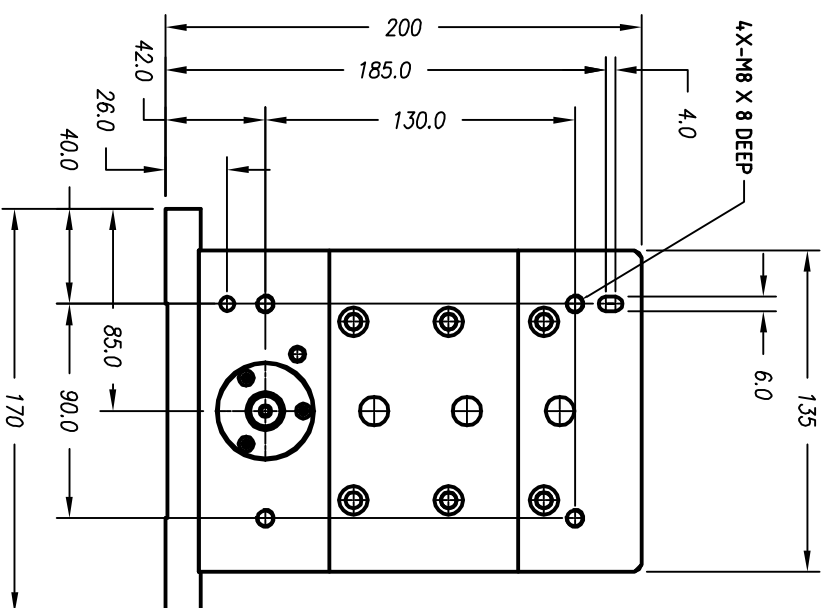

SIGNATURE NEEDED FOR ORDER APPROVAL
 SIGN _____ DATE _____
 APPROVAL NOT RECEIVED WITHIN
 48 HOURS MAY AFFECT DELIVERY

REV	DATE	ECN	DESCRIPTION	APP
A	4/26/06	3916	INITIAL RELEASE	TW
B	9/6/06	4018	SEE ECN	LR
C	9/15/06	4022	SEE ECN	LR
D	10/1/13	5288	SEE ECN	KGS
E	1/19/16	5688	PART NUMBER CHANGE	SB

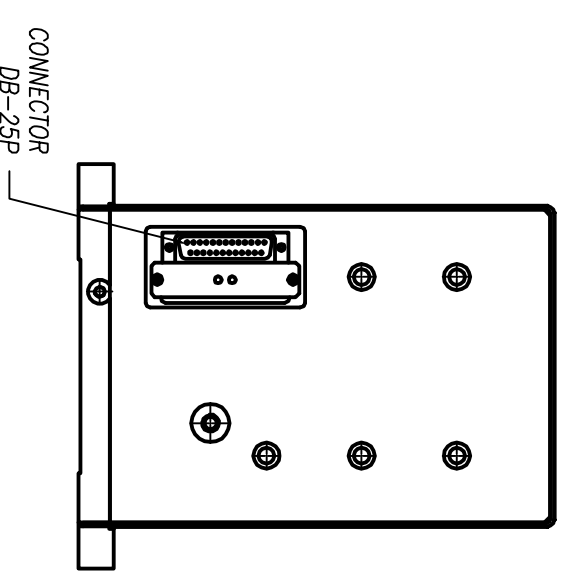
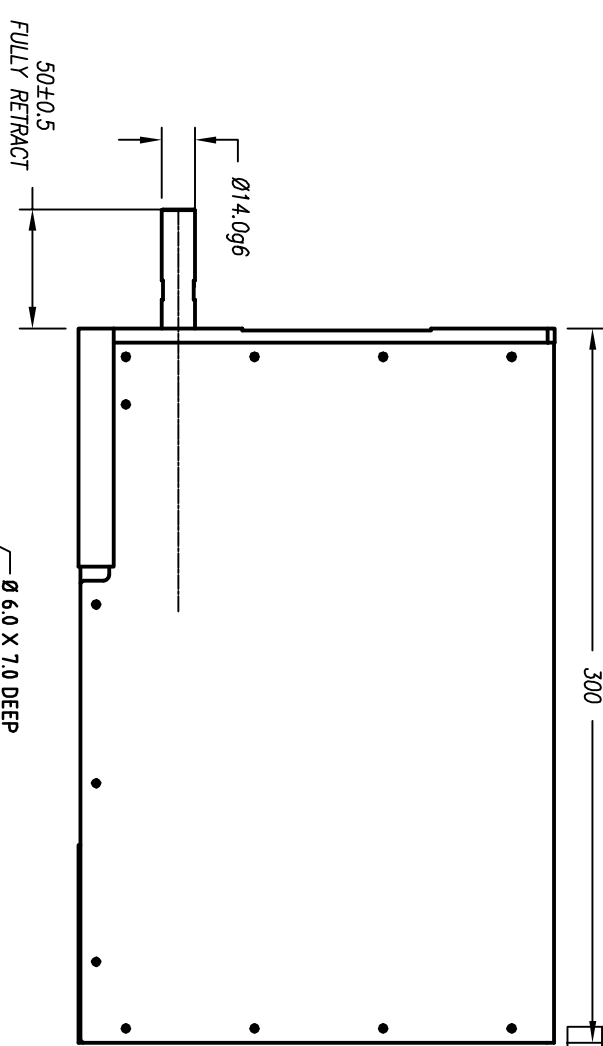

DB-25P CONNECTOR PIN OUT (AXIS 1=LINEAR)			
1	+5VDC	14	AXIS 1 ENCODER PHASE A+
2	+5V RETURN	15	NC
3	NC	16	AXIS 1 ENCODER PHASE B+
4	AXIS 1 ENCODER PHASE A-	17	NC
5	OVER HEAT	18	AXIS 1 ENCODER INDEX Z+
6	AXIS 1 LIMIT/OH RETURN	19	AXIS 1 MOTOR -
7	AXIS 1 MOTOR +	20	AXIS 1 MOTOR -
8	AXIS 1 MOTOR +	21	NC
9	AXIS 1 ENCODER PHASE B-	22	NC
10	NC	23	AXIS 1 ENCODER INDEX Z-
11	AXIS 1 LIMIT +	24	NC
12	AXIS 1 LIMIT -	25	NC
13	NC		

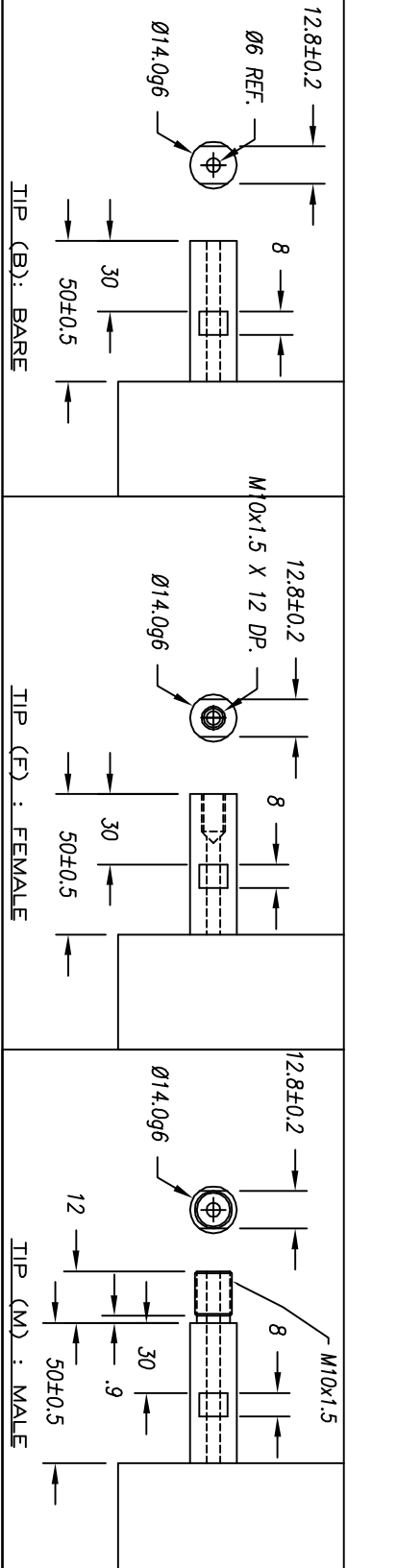
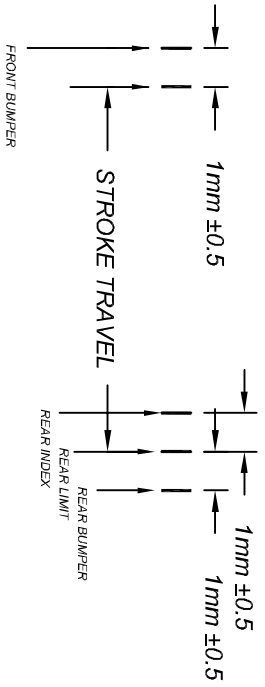
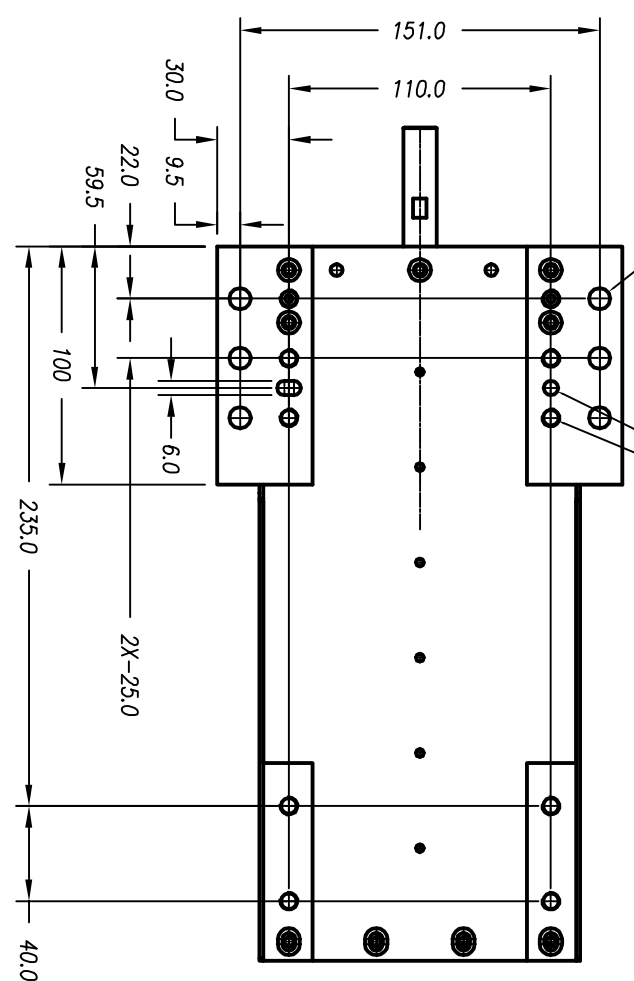

TOLERANCES ARE: X: ± 0.50 X.X ± 0.1 X.XX ± 0.05 X.XXX ± ANGULARITY ± 0.1° CONCENTRIC ± 0.01 ROUNDNESS ± 0.05 EDGE BREAK 0.2 MAX CHAMFER 0.2 MAX		MATERIAL: ALUMINUM 6061-T6		DESIGNED BY: TOAN VU DATE: 4/26/06		REF. NUMBER LAL500-050-8	
HEAT TREAT: RC DEEP		MACHINE FINISH: 3.2 / ✓		DRAWN BY: KARL STOCKS DATE: 10/1/13		CHECKED BY: APPROVED BY:	
EXCEPT NOTED. PROTECTIVE FINISH ELECTROLESS NICKEL		PART NAME: LAL500-050-7X-2		SCALE: NONE		DWG SIZE: B	
FILE NAME: LAL500-050-8_D		SPEC. NUMBER:		DO NOT SCALE DWG		PART NUMBER: LAL500-050-7X-2	
CONTRACT: STD				SHEET NUMBER: 1 OF 1			
REVISION: E							

SMAC