

NOTES: (UNLESS OTHERWISE SPECIFIED)
 PEAK FORCE: 24KGF (48V @ 3 AMPS)
 FORCE CONSTANT: 8KG/AMP
 STROKE: 50mm
 MOVING MASS: 800g
 ENCODER RESOLUTION: 0.5, 1.0, 5.0µM
 COIL DC RESISTANCE: 16 OHMS
 OPERATING TEMP: 0° TO 45°C
 ALL DIMENSIONS ARE IN MM

SIGNATURE NEEDED FOR ORDER APPROVAL
 DATE _____
 APPROVAL NOT RECEIVED WITHIN
 48 HOURS MAY AFFECT DELIVERY

REVISIONS			
REV	DATE	ECN	DESCRIPTION
C	10/21/02	2603	SEE ECN
D	3/2/04	3070	SEE ECN
E	10/1/13	5288	SEE ECN
F	1/19/16	5688	PART NUMBER CHANGE

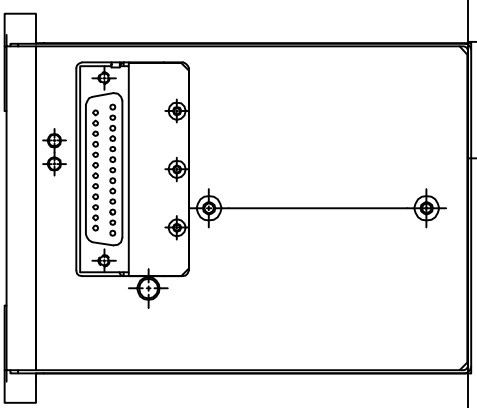
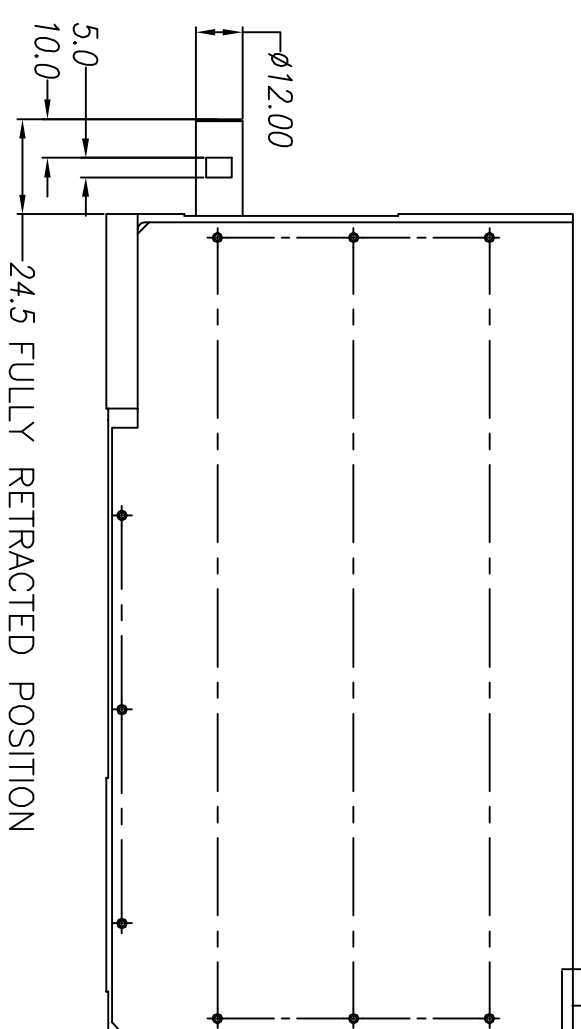
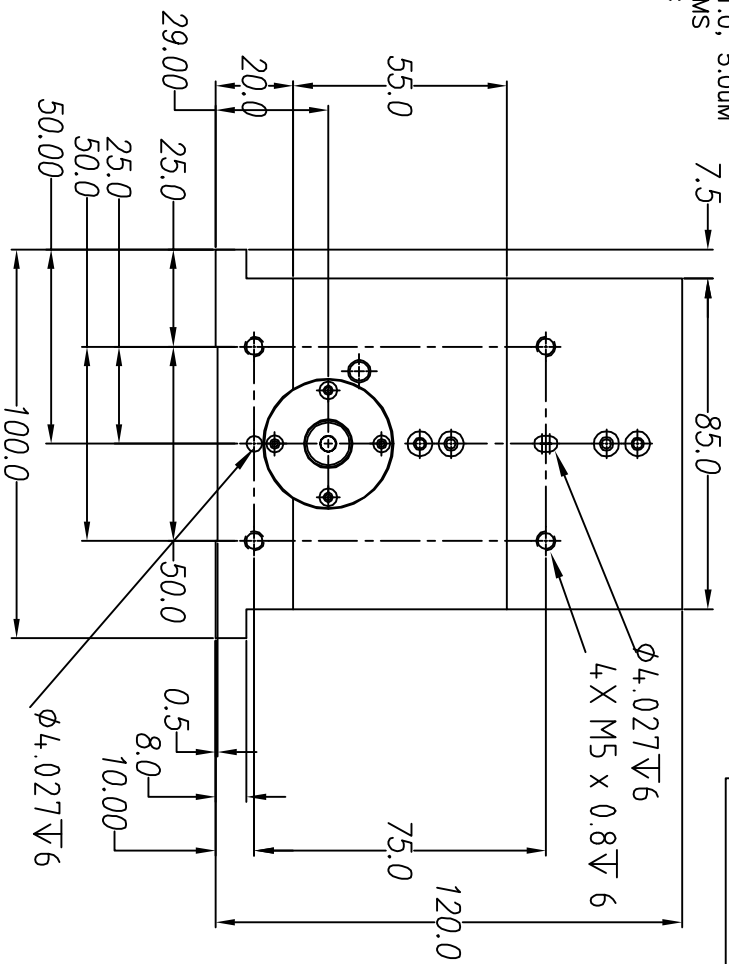

DB-25P PINOUT

1	+5VDC	14	LINEAR PHASE A +
2	+5V RETURN	15	NO CONNECTION
3	NO CONNECTION	16	LINEAR PHASE B +
4	LINEAR PHASE A -	17	NO CONNECTION
5	OVER HEAT	18	LINEAR INDEX +
6	LIMIT RETURN	19	COIL -
7	COIL +	20	COIL -
8	COIL +	21	NO CONNECTION
9	LINEAR PHASE B -	22	NO CONNECTION
10	NO CONNECTION	23	LINEAR INDEX -
11	LIMIT + (TBD)	24	NO CONNECTION
12	LIMIT - (TBD)	25	NO CONNECTION
13	NO CONNECTION		

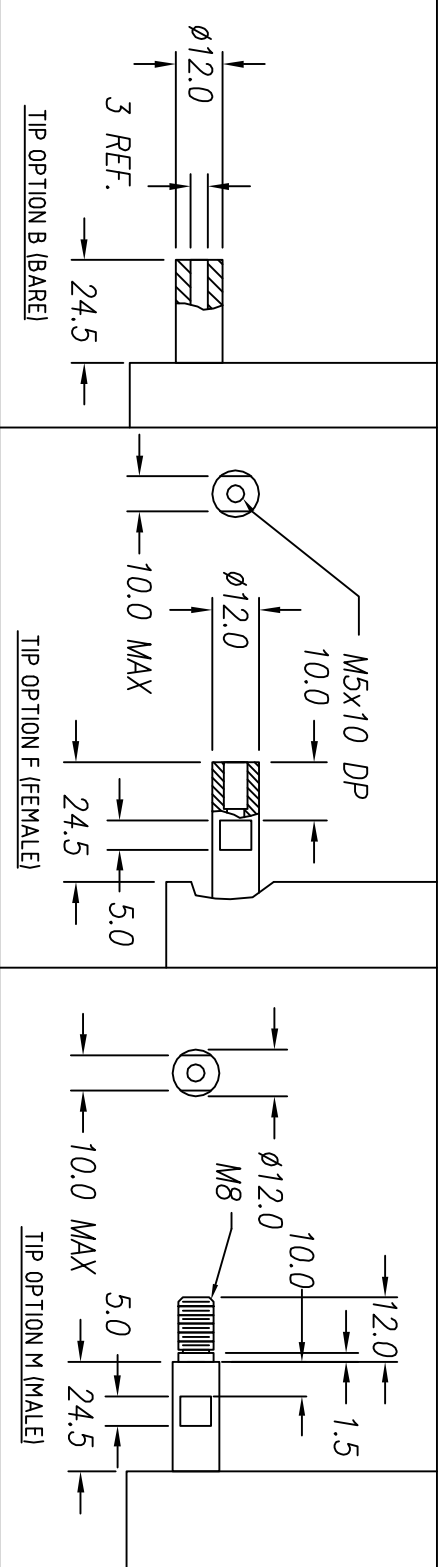
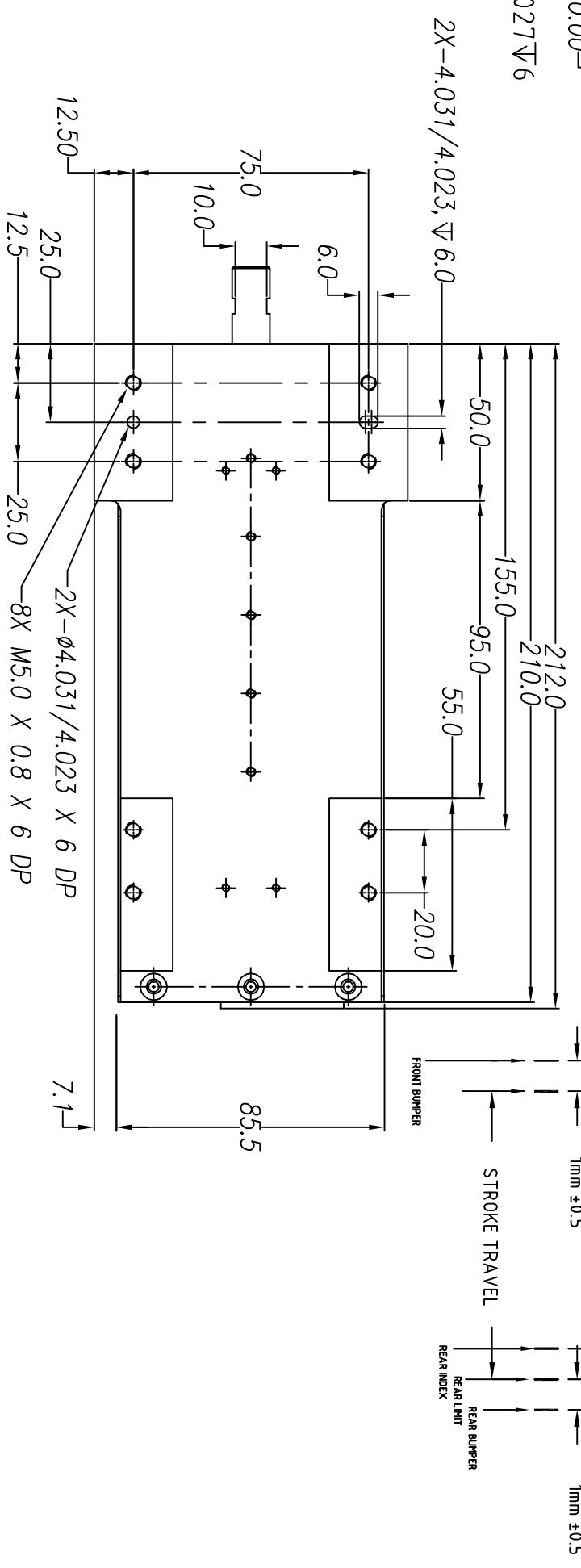

TOLERANCES ARE: X ± 0.50 XX ± 0.1 XXX ± 0.05 X.XXX ± ANGULARITY ± 0.1° CONCENTRIC ± 0.01 ROUNDNESS ± 0.05 EDGE BREAK 0.2 MAX CHAMFER 0.1 MAX		MATERIAL: HEAT TREAT: / RC MACHINE FINISH: DEEP EXCEPT NOTED. 1.6 / PROTECTIVE FINISH FILE NAME: LAL300-50	
SMAC		REF. NUMBER: LAL300-050-8	
DESIGNED BY: SMH	DATE: 3/2/04	CHECKED BY:	DATE:
DRAWN BY: KGS	DATE: 10/1/13	APPROVED BY:	DATE:
PART NAME: LAL300-050-7X-2 OUTLINE		CONTRACT: STD	
SCALE: NONE	DWG SIZE: SMH	PART NUMBER: LAL300-050-7X-2	SHEET NUMBER: 1 OF 1
DO NOT SCALE DWG			REVISION: F