

**LINEAR SPECIFICATONS:**

LINEAR STROKE: 30 +1/-0 mm  
 PEAK FORCE: 115N @ 48V  
 ACCELERATION: 25G (PEAK)  
 FORCE CONSTANT: 76 N/A  
 COIL RESISTANCE: 29 Ohms  
 ENCODER RESOLUTION: 5,1,0.5 μm  
 ENCODER REPEATILITY: ±2 ENCODER COUNT  
 MOVING MASS: 450 grams  
 TOTAL MASS: 4.8 kg  
 LINEAR GUIDE: MLG12C1  
 OPERATING TEMPERATURE: 0°C TO 40°C  
 ALL DIMENSIONS ARE IN mm

REVISION HISTORY				
REV	DATE	ECN	DESCRIPTION	APPROVED
E	7/28/2015		PROPOSAL	TOAN VU

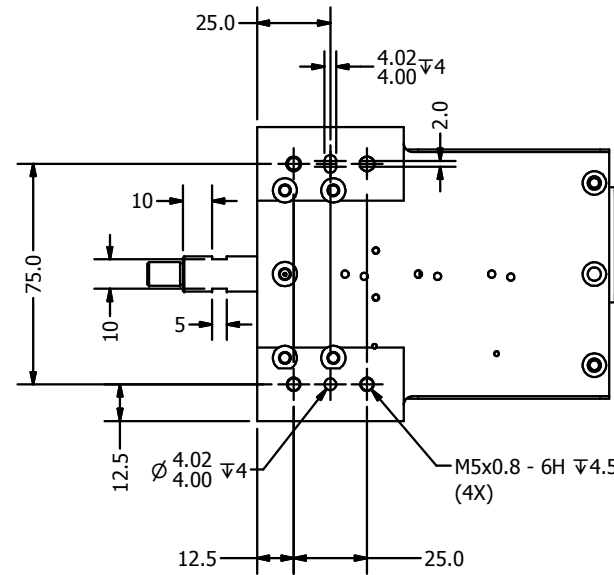
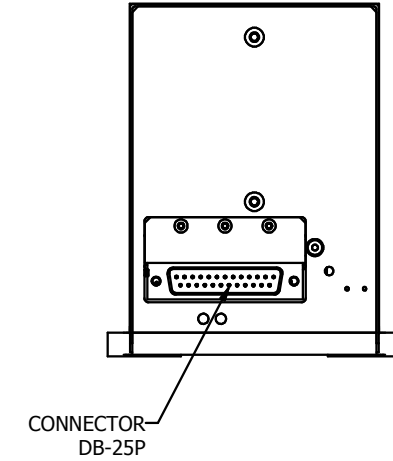
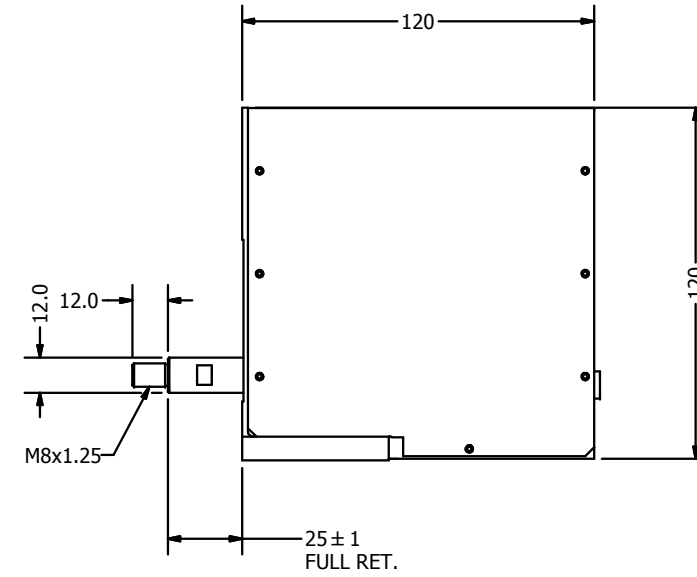
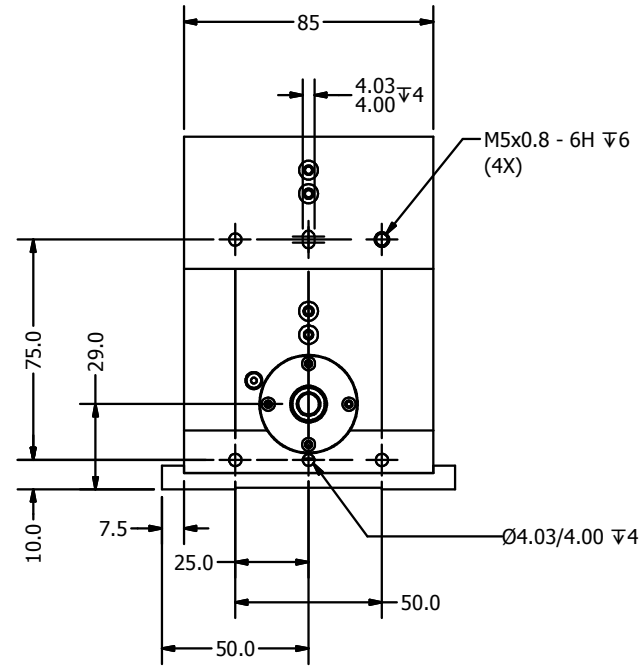

DB-25P PINOUT	
1	+5VDC
2	+5V RETURN
3	NC
4	LINEAR PHASE A-
5	NC
6	NC
7	COIL +
8	COIL +
9	LINEAR PHASE B-
10	NC
11	NC
12	NC
13	NC
14	LINEAR PHASE A+
15	NC
16	LINEAR PHASE B+
17	NC
18	LINEAR INDEX -
19	COIL -
20	COIL -
21	NC
22	NC
23	LINEAR INDEX +
24	NC
25	NC

TOLERANCES ARE:		<b>SMAC</b>		REF. NUMBER	
X ± 0.50				LAL300-30	
X.X ± 0.1		DESIGNED BY:		DATE:	
X.XX ± 0.05		TMV		7/27/2015	
X.XXX ± 0.01		DRAWN BY:		APPROVED BY:	
ANGULARITY ± 0.1°		ToanVu		7/28/2015	
CONCENTRIC ± 0.01		MACHINE FINISH:		PART NAME:	
ROUNDNESS ± 0.05		3.2/		LAL300-030-7X	
EDGE BREAK 0.02 MAX		EXCEPT NOTED		SHEET NUMBER:	
CHAMFER 0.03 MAX		NICKEL		1 OF 1	
FILE NAME:		SCALE:		REVISION:	
LAL300-030-7X_E.idw		NONE		E	
SPEC. NUMBER:		DWG SIZE:		PART NUMBER:	
		C		LAL300-030-7X	
		DO NOT SCALE DWG			