

FUNCTION	COLOR
MOTOR U	BLUE (S10M)
MOTOR V	BROWN (S10M)
MOTOR W	PURPLE (S10M)

动力线端子: (剥线5 捕锡)
L ≥ 100

Power Wire

技术要求:
定子引出线按GB/T 7345-2008要求:
对定子三相线, 每根引出线应能承受9.0N的拉力;
引出线不能断开, 绝缘层和线芯不能损坏。

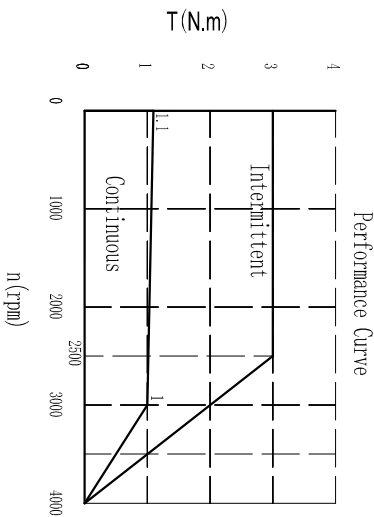
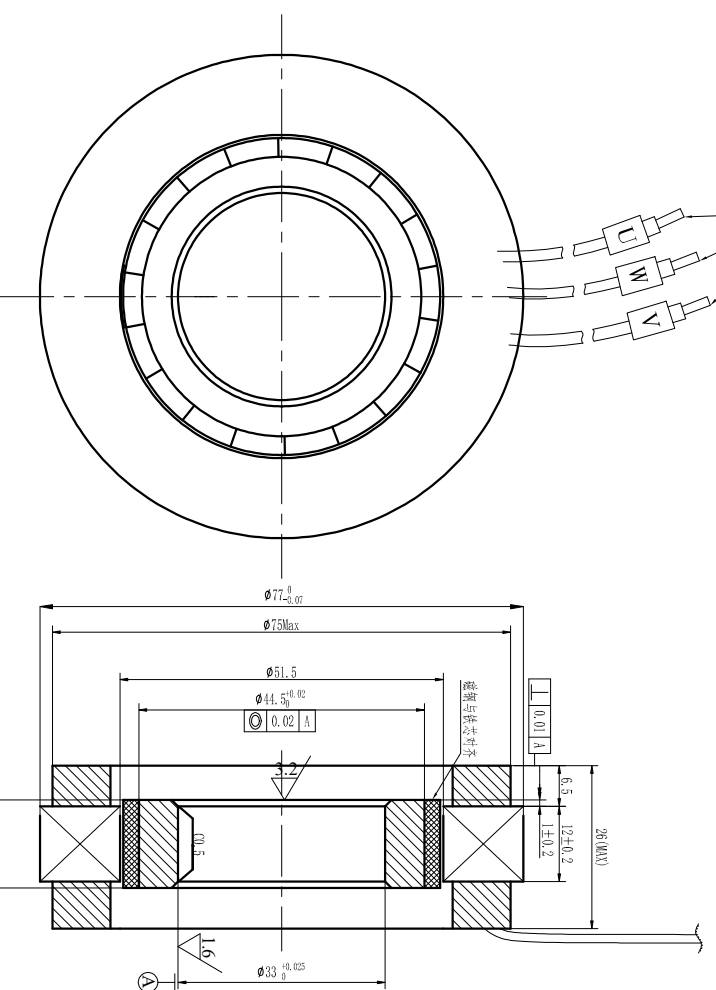

DC BRUSHLESS SERVO MOTOR
FMC077-2-0031-3033N-8DS00

W	314	V	48
A	7.65	Nm	1
RPM	3000	Ins	F

Kinavo Servo Motor (Changzhou) Ltd.
MADE IN CHINA
S/N: 307080XXXXYYDDNNNN

Technical Data	
No. of poles	16
DC Link Voltage U _c (DC Link)	48
Rated Power P _n (W)	314
Rated torque T _n (N.m)	1
Rated Speed n (rpm)	3000
Rated Current I _n (A)	7.65
Maximum torque T _m (N.m)	3
Maximum Current I _m (A)	24
Standstill torque T _s (N.m)	1.1
Standstill current I _s (A)	8.42
Resistance line-line R _{ll} (Ω)	0.31
Inductance line-line L _{ll} (mH)	0.8
Electrical time constant τ _e (ms)	2.5
Mechanical time constant τ _m (ms)	1.45
Voltage constant K _v (V/krpm)	8.4
Torque constant K _t (Nm/A)	0.1
Rotor moment of inertia J _m (kg.cm ²)	0.522
Insulation class	F
Weight (kg)	0.32
Feet back device	
Temperature Sensor	
Cooling method	Totally enclosed non-ventilated
Temperature	guarantee the measured winding temperature is between 20°C and 120°C
Humidity	Below 90%RH (No deicing)
Environment	For any active gas, combustible gas, oil drop, ash.
Installation altitude	IP 10, 1000m-rated power, above 1000m, 5% power, decreasing per 10m, max. 3000m

REV	ECN NO.	DRN	APP'D	DATE	P.N.
				22-03-02	30708033ASS
UNLESS OTHERWISE SPECIFIED		MATERIAL		CHECK	DATE
TOLERANCES		ANGULAR		LSJ	22-03-02
DECIMALS: ±0.5		±0° 30'		APPD	22-03-02
.XX ±0.25				SL	
.XXX ±0.1				SCALE	
UNIT: mm				SHEET	OF
DO NOT SCALE DRAWING				KINAVO MOTOR	